

NAIL FIN INSTALLATION

PREMIUM ATL VINYL FIXED WINDOW

Max Frame	DP RATING	IMPACT
52 1/8 x 75	+/-65	NO

- Installation Notes:**
1. Seal flange/frame to substrate.
 2. Use #10 PH or greater fastener through the nail fin with sufficient length to penetrate a minimum of 1 1/2" into the wood framing. For 2X wood frame substrate (min. S.G. = 0.42).
 3. Host structure (wood buck, masonry, steel) to be designed and anchored to properly transfer all loads to the structure. The host structure is the responsibility of the architect or engineer of record for the project of installation.

This schedule addresses only the fasteners required to anchor the window to achieve the rated design pressure up to the size limitations noted. It is not intended as a guide to the installation process and does not address the sealing consideration that may arise in different wall conditions. For the complete installation procedure, see the instructions packaged with the window or go to www.jeld-wen.com/resources/installation.

DISCLAIMER:

This drawing and its contents are confidential and are not to be reproduced or copied in whole or in part or used or disclosed to others except as authorized by JELD-WEN Inc.

HERMES F. NOBRO
PROFESSIONAL ENGINEER
 NO. 733778
 STATE OF FLORIDA

398 East. Dania Beach Blvd., Suite 398
 Dania Beach, FL 33004

PROJECT ENGINEER:	DATE:
DRAWN BY:	SCALE:
CHECKED BY:	TITLE:
APPROVED BY:	
PART/PROJECT NO.:	
IDENTIFIER NO.:	PLANT NAME AND LOCATION:
NCT1210-3910-1-FBC	

JELD-WEN

3737 Lakeport Blvd
 Klamath Falls, OR, 97601
 Phone: (541) 882-3451

Premium Atlantic Vinyl Fixed
 Nail Fin Installation (52.125" x 75")

CAD DWG. No.: REV: 00 SHEET 1 OF 4

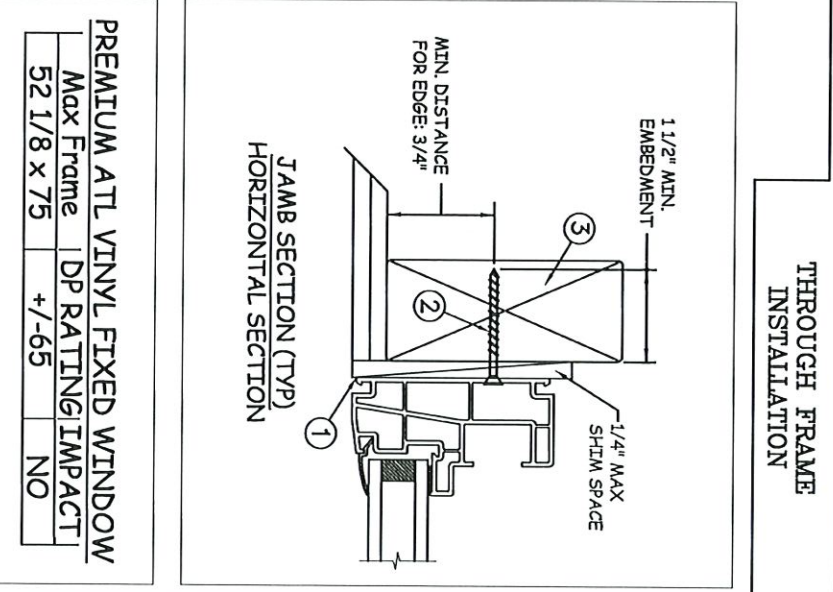
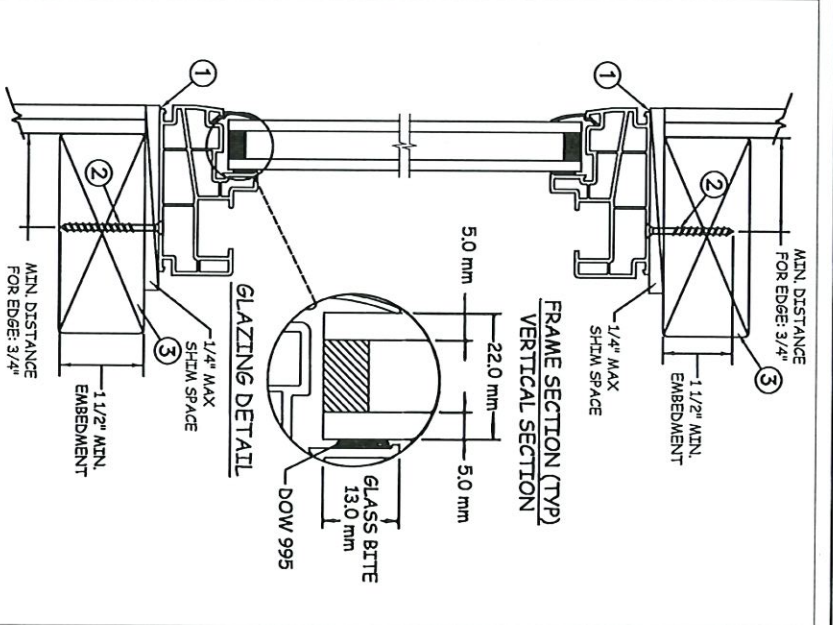
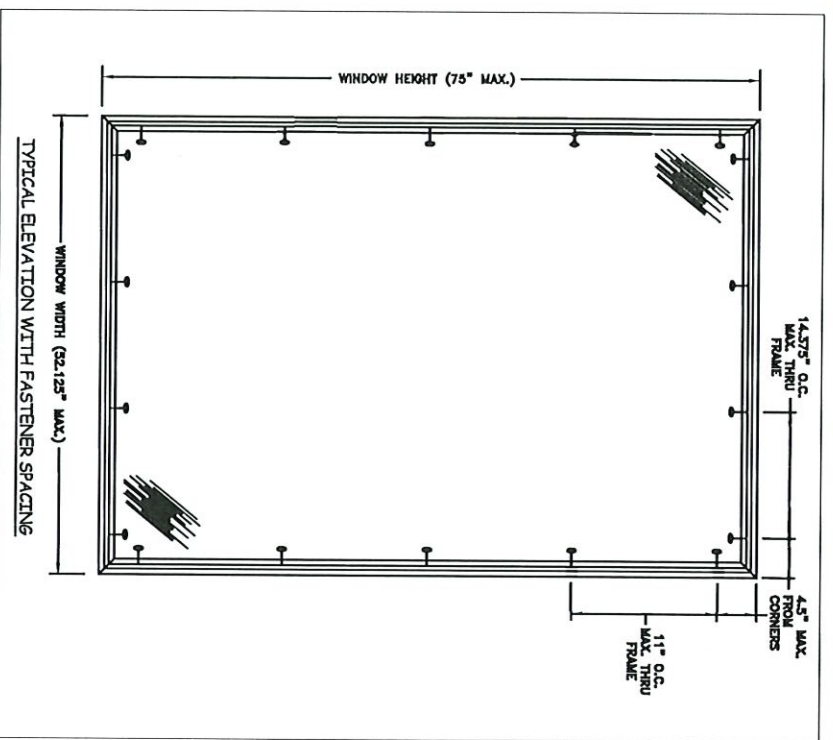

- Installation Notes:**
1. Seal flange/frame to substrate.
 2. Use #10 PH or greater fastener through the frame with sufficient length to penetrate a minimum of 1 1/2" into the wood framing. For 2X wood frame substrate (min. S.G. = 0.42).
 3. Host structure (wood buck, masonry, steel) to be designed and anchored to properly transfer all loads to the structure. The host structure is the responsibility of the architect or engineer of record for the project of installation.

This schedule addresses only the fasteners required to anchor the window to achieve the rated design pressure up to the size limitations noted. It is not intended as a guide to the installation process and does not address the sealing consideration that may arise in different wall conditions. For the complete installation procedure, see the instructions packaged with the window or go to www.jeld-wen.com/resources/installation.

DISCLAIMER:

This drawing and its contents are confidential and are not to be reproduced or copied in whole or in part or used or disclosed to others except as authorized by JELD-WEN Inc.

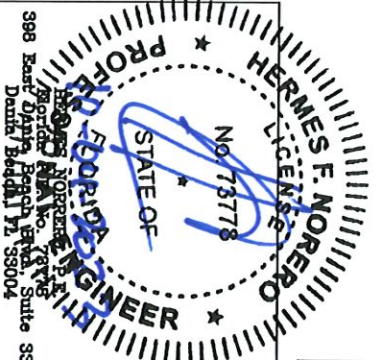

- General Notes:**
1. The product shown herein is designed, tested and manufactured to comply with the wind load criteria of the adopted International Building Code(IBC), the International Residential Code(IRC), the Florida Building Code(FBC), including HVHZ and the industry requirement for the stated conditions.
 2. All glazing shall conform to ASTM E1300.
 3. At minimum, glazing shall be 5 mm tempered glass / 13 mm airspace / 5 mm tempered glass.
 4. Use structural or composite shims where required.
 5. Installation methods can be interchanged within the same opening.
 6. An impact protective system is required where wind borne debris protection is mandated by local building code.
 7. Maximum sizes are buck sizes and do not include fin or flange.

PROJECT ENGINEER:	DATE:	10/15/2013
DRAWN BY:	SCALE:	NTS
D. VEZO	TITLE:	Premium Atlantic Vinyl Fixed Through Frame Installation (52.125" x 75")
CHECKED BY:	J. Kantola	
APPROVED BY:		
PART/PROJECT NO.:	D009460	
IDENTIFIER NO.:	NCT1210-3910-1-FBC	
PLANT NAME AND LOCATION:		
CAD DWG. NO.:		
REV.:	00	
SHEET:		2 OF 4

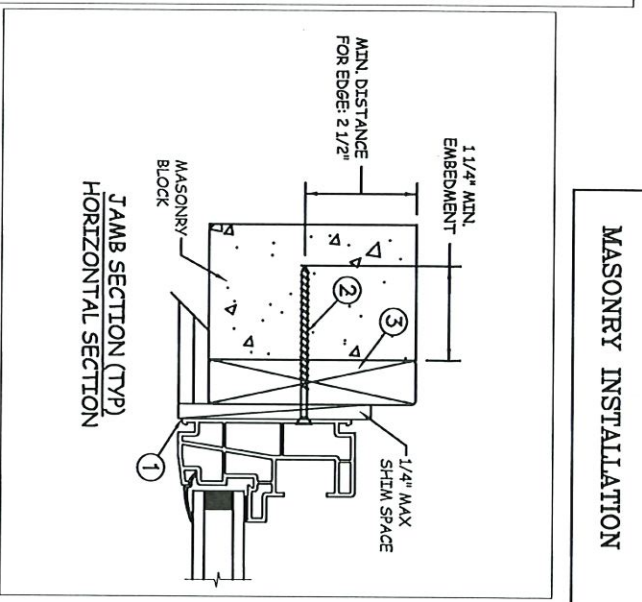
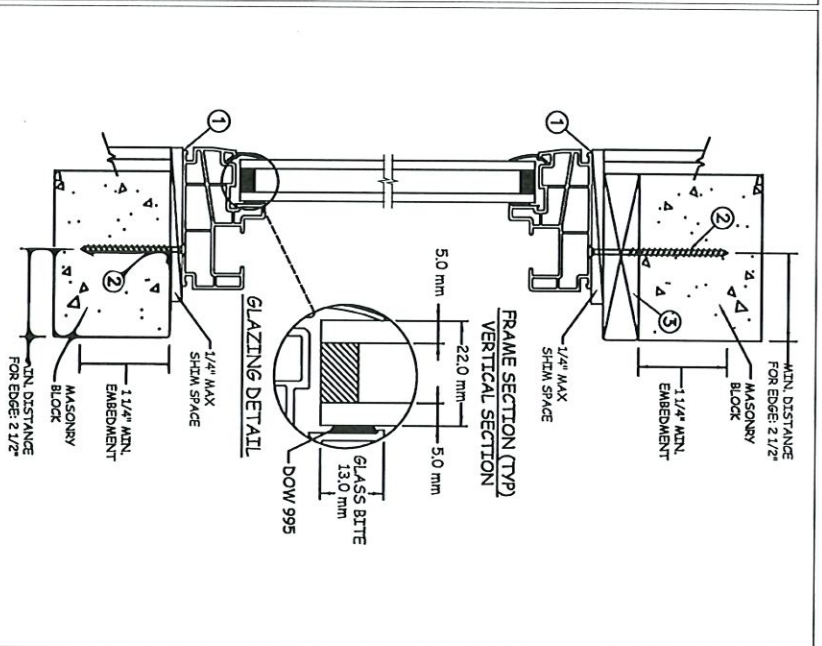
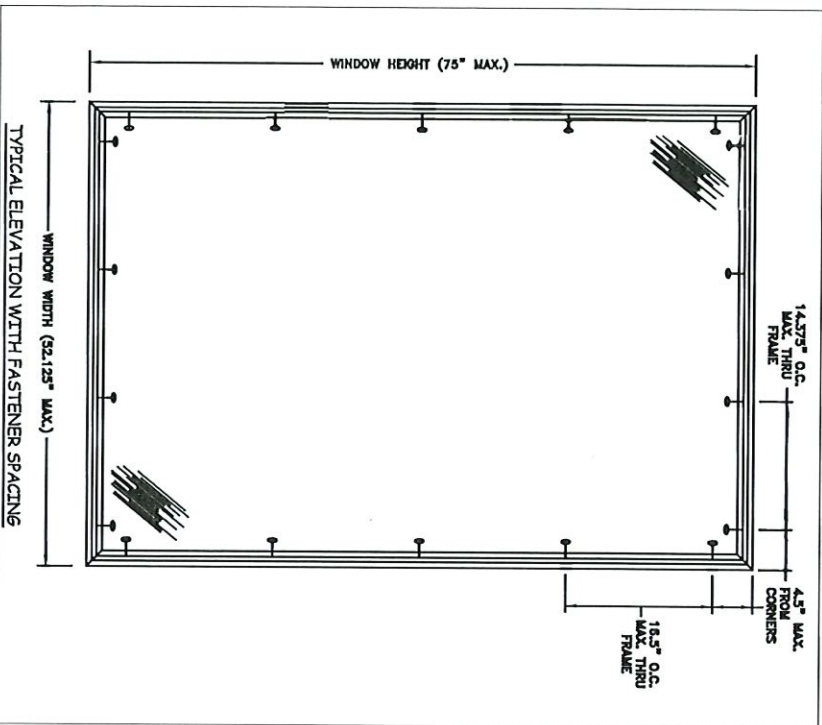

PREMIUM ATL VINYL FIXED WINDOW

Max Frame	DP RATING/IMPACT
52 1/8 x 75	+/-65 NO

- Installation Notes:**
1. Seal flange/frame to substrate.
 2. Use 3/16" Tapcon or equivalent fasteners through frame with sufficient length to penetrate a minimum of 1 1/4" into concrete or masonry at each location with a 2 1/2" min from edge distance. For concrete (min. $f_c = 3000\text{psi}$) or masonry substrate (CMU shall adhere to ASTM C90).
 3. Host structure (wood buck, masonry, steel) to be designed and anchored to properly transfer all loads to the structure. The host structure is the responsibility of the architect or engineer of record for the project of installation.

- General Notes:**
1. The product shown herein is designed, tested and manufactured to comply with the wind load criteria of the adopted International Building Code(IBC), the International Residential Code(IRC), the Florida Building Code(FBC), including HVHZ and the industry requirement for the stated conditions.
 2. All glazing shall conform to ASTM E1300.
 3. At minimum, glazing shall be 5 mm tempered glass / 13 mm airspace / 5 mm tempered glass.
 4. Use structural or composite shims where required.
 5. Installation methods can be interchanged within the same opening.
 6. An impact protective system is required where wind borne debris protection is mandated by local building code.
 7. Maximum sizes are buck sizes and do not include fin or flange.

This schedule addresses only the fasteners required to anchor the window to achieve the rated design pressure up to the size limitations noted. It is not intended as a guide to the installation process and does not address the sealing consideration that may arise in different wall conditions. For the complete installation procedure, see the instructions packaged with the window or go to www.jeld-wen.com/resources/installation.

DISCLAIMER:
This drawing and its contents are confidential and are not to be reproduced or copied in whole or in part or used or disclosed to others except as authorized by JELD-WEN Inc.

HERMES F. NOREPO
REGISTERED PROFESSIONAL ENGINEER
No. 73778
STATE OF FLORIDA

APPROVED BY:
J. Kantola

PROJECT ENGINEER:
D. VEZO

PART PROJECT NO.:
D009460

IDENTIFIER NO.:
NCT1210-3910-1-FBC

PLANT NAME AND LOCATION:

CAD DWG. NO.:

REV.: 00

SHEET: 3 OF 4

JELD-WEN

3737 Lakeport Blvd
Klamath Falls, OR, 97601
Phone: (541) 882-3451

Premium Atlantic Vinyl Fixed
Masonry Installation (52.125" x 75")

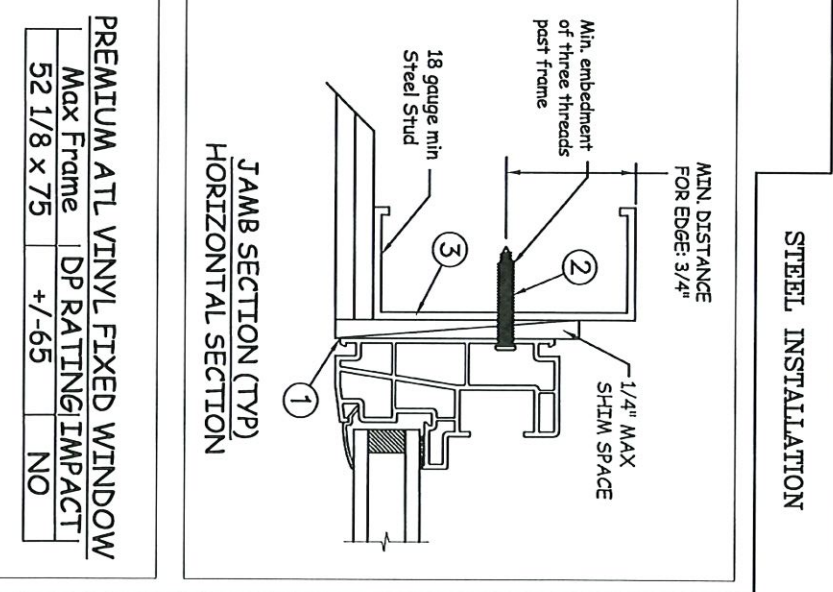
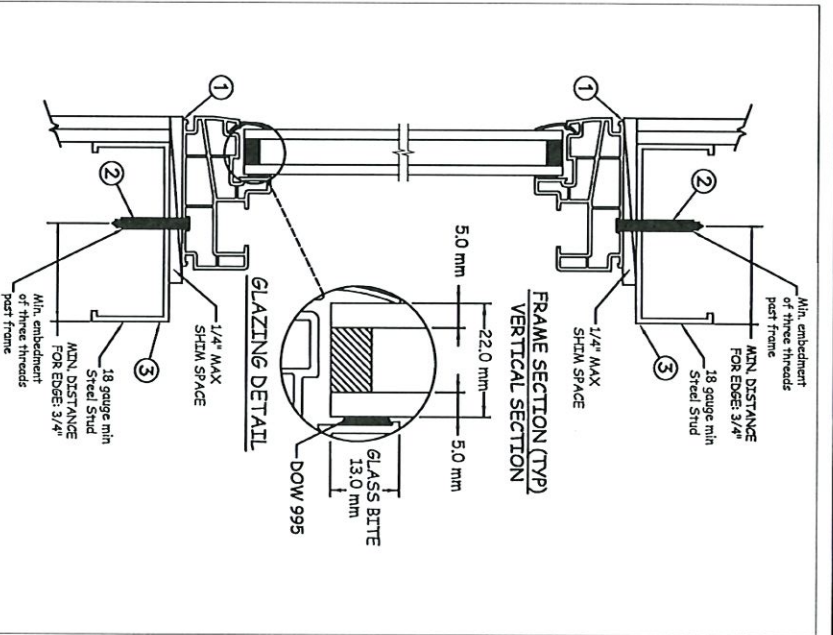
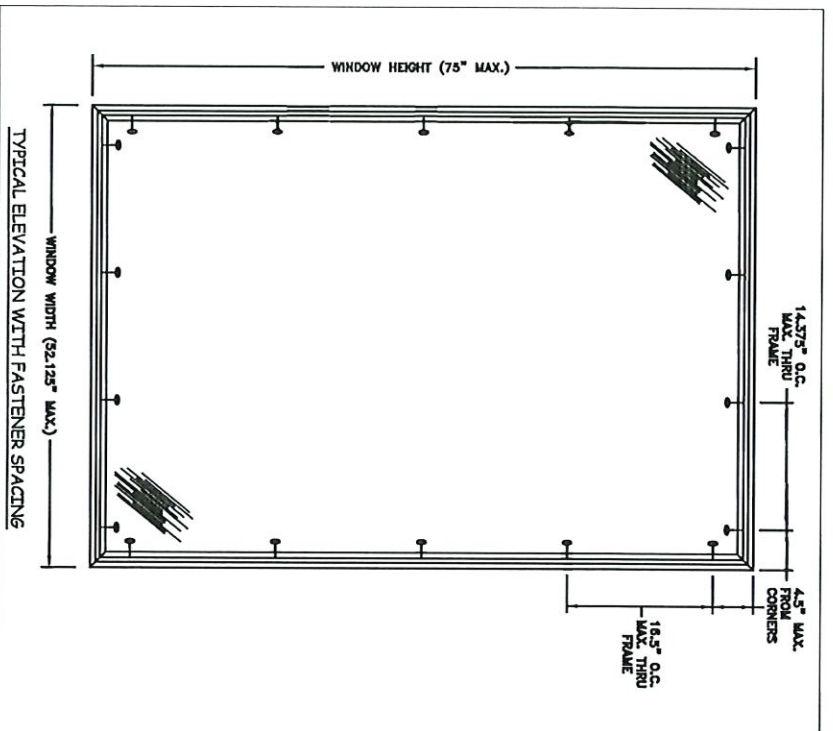

PREMIUM ATL VINYL FIXED WINDOW

Max Frame	DP RATING: IMPACT
52 1/8 x 75	+/-65
	NO

- Installation Notes:**
1. Seal flange/frame to substrate.
 2. For anchoring into metal framing use #10 TEK Self Tapping screws with sufficient length to achieve a minimum embedment of three threads past the frame thickness. Steel substrate min. 18ga. fy = 33 ksi.
 3. Host structure (wood buck, masonry, steel) to be designed and anchored to properly transfer all loads to the structure. The host structure is the responsibility of the architect or engineer of record for the project or installation.

- General Notes:**
1. The product shown herein is designed, tested and manufactured to comply with the wind load criteria of the adopted International Building Code(IBC), the International Residential Code(IRC), the Florida Building Code(FBC) including HVHZ and the industry requirement for the stated conditions.
 2. All glazing shall conform to ASTM E1300.
 3. At minimum, glazing shall be 5 mm tempered glass / 13 mm airspace / 5 mm tempered glass.
 4. Use structural or composite shims where required.
 5. Installation methods can be interchanged within the same opening.
 6. An impact protective system is required where wind borne debris protection is mandated by local building code.
 7. Maximum sizes are buck sizes and do not include fin or flange.

This schedule addresses only the fasteners required to anchor the window to achieve the rated design pressure up to the size limitations noted. It is not intended as a guide to the installation process and does not address the sealing consideration that may arise in different wall conditions. For the complete installation procedure, see the instructions packaged with the window or go to www.jeld-wen.com/resources/installation.

DISCLAIMER:
This drawing and its contents are confidential and are not to be reproduced or copied in whole or in part or used or disclosed to others except as authorized by JELD-WEN Inc.

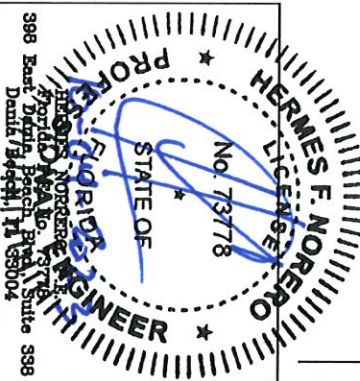

PROJECT ENGINEER:	DATE:	10/15/2013
DRAWN BY:	SCALE:	NTS
D. VEZO	TITLE:	Premium Atlantic Vinyl Fixed Steel Installation (52.125" x 75")
CHECKED BY:		
J. KANTOLA		
APPROVED BY:		
PART PROJECT NO:		
D0099460		
IDENTIFIER NO:	PLANT NAME AND LOCATION:	
NCT1210-3910-1-FBC		
CAD DWG. No.:	REV:	00
	SHEET:	4 OF 4

JELD-WEN
3737 Lakeport Blvd
Klamath Falls, OR, 97601
Phone: (541) 882-3451